

Large Outerframe

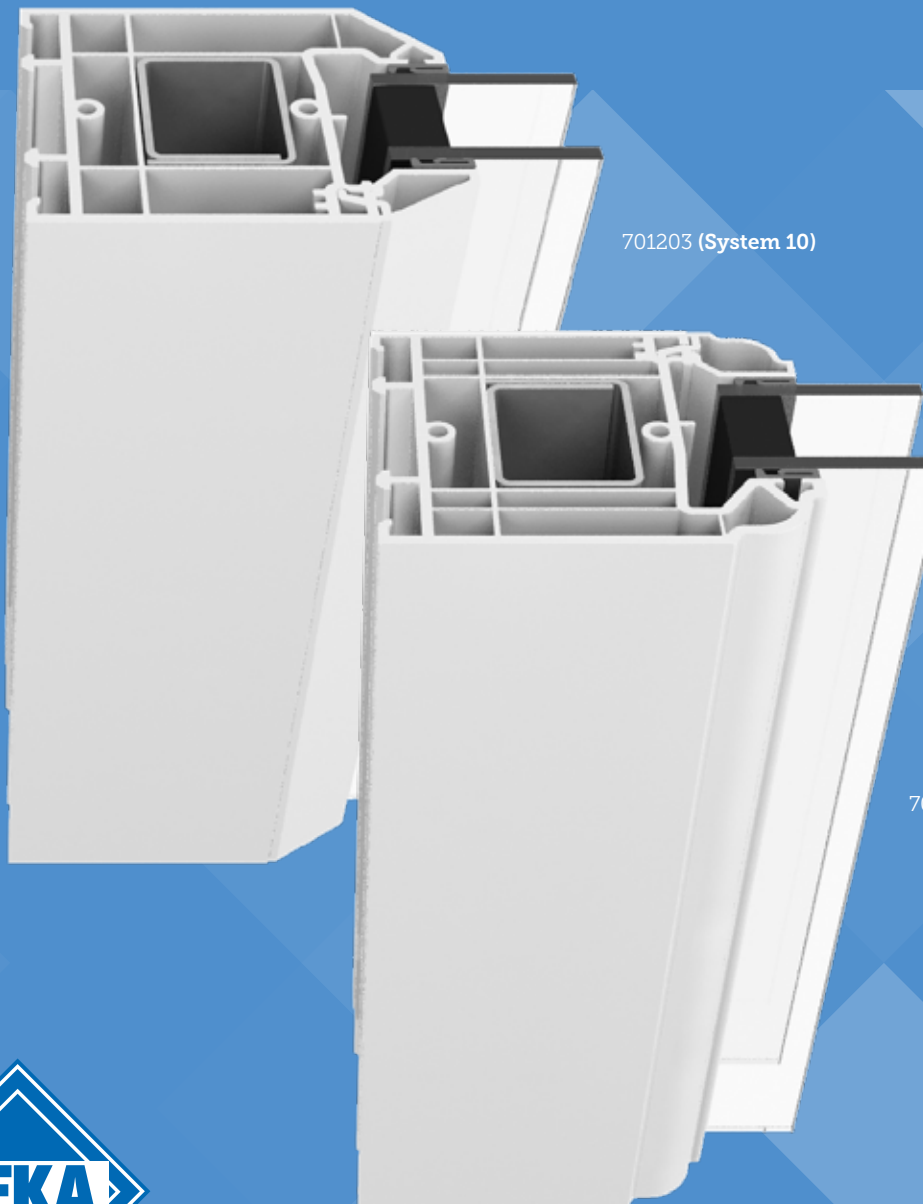

701204 (Rustique) 701203 (System 10)





Halo Outerframe information

Available to order via **E-Shop**



Code: **701204 (Rustique) 701203 (System 10)**

Halo fabricators are now able to access the benefits brought by the addition of a large outerframe to the Rustique and System 10 ranges.

Rather than using a frame extension to the 72mm outerframe, the 84mm option provides a simple solution with more benefits for fabricators, installers and homeowners.

Pack Quantity – 2 lengths
Minimum Order Quantity – 1 pack

Features & Benefits

- Large outerframe allows more hinge-side plasterline clearance on residential doors without the addition of a 15mm frame extension.
- One stock item instead of the outerframe and the frame extender – especially useful on coloured frames
- No unsightly join line where extension meets the frame.
- No mismatch of foils on the extension when running alongside each other
- Same reinforcing as used in the 72mm outer – no additional stock items
- All hardware used on the 72mm outerframe can also be used on the 84mm outerframe
- Available in colours across the Variations offer
- Both chamfered and sculptured options available

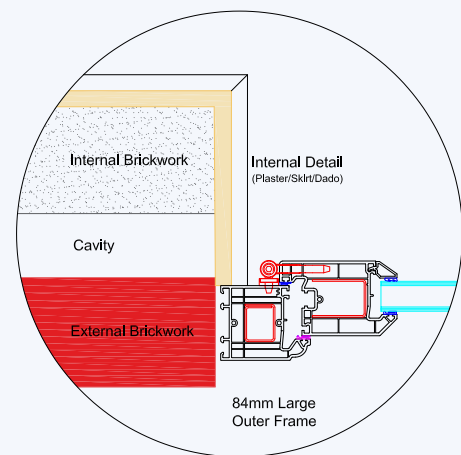

Rustique

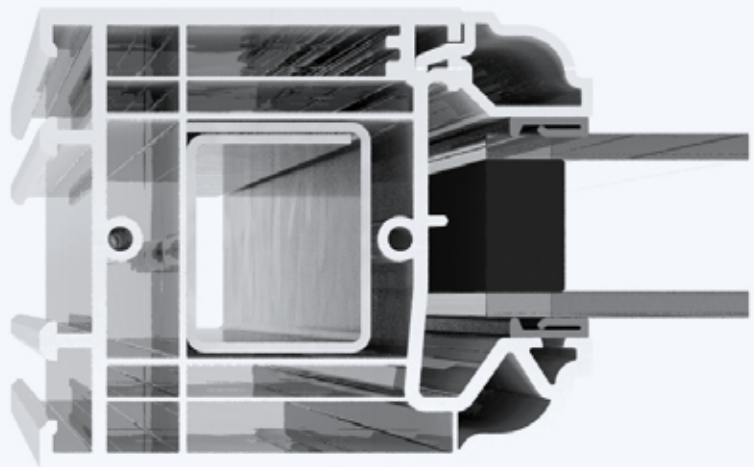

System 10

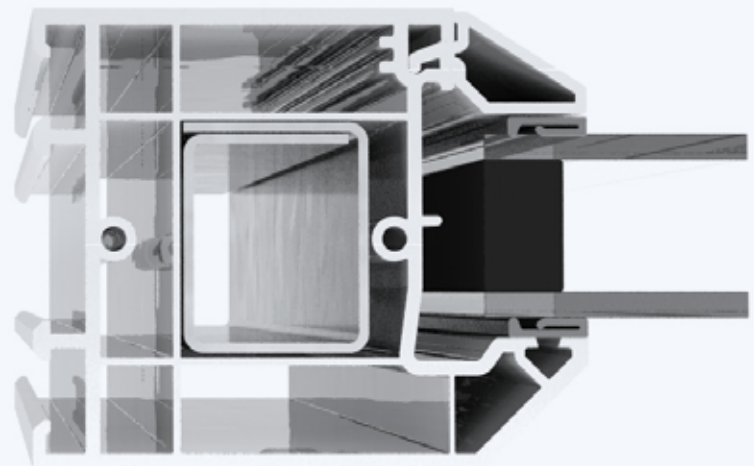

VEKA plc

Farrington Road
Rossendale Road Ind. Est.
Burnley, Lancashire
BB11 5DA

Tel: 01282 716611
Fax: 01282 725257
salesenquiry@veka.com
www.veka.com



Images are for illustration purpose only. We reserve the right to change product specification at any time.
Due to the limitations of the printing process we recommend that an accurate colour swatch is requested prior to ordering.
The company cannot accept any responsibility for colours or images shown in this brochure.
All information within this brochure is correct at time of going to print.



FOR NOW
FOR THE FUTURE
FOR LIFE